

FOUR JAW HAND OPERATED INDEPENDENT CHUCK

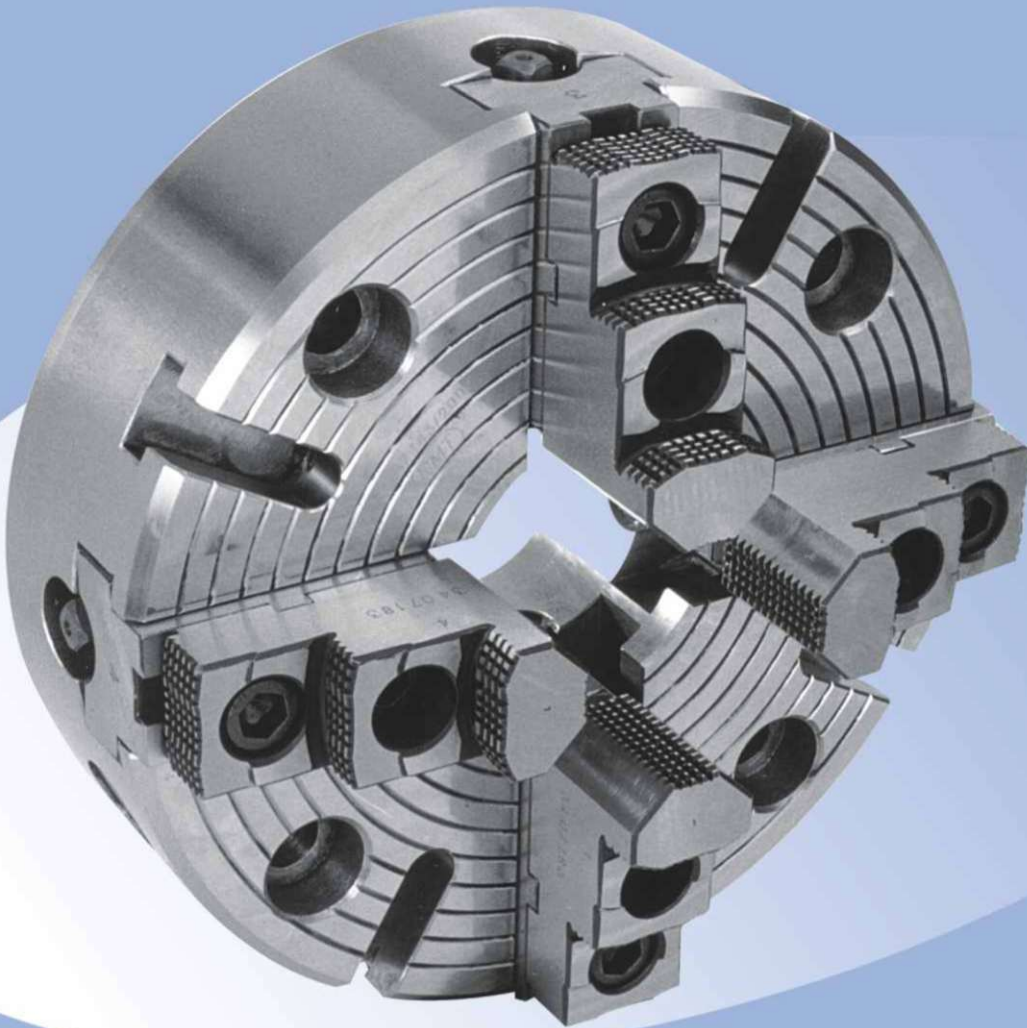

Following features of the GMT four jaw chuck makes this chuck superior to other four jaw independent chucks available.

The chuck body is made of forged medium carbon steel. It is hardened and tempered to ensure long life and strength to the chuck body. Base jaw slots in the body are precision ground to close tolerances for obtaining a good sliding fit, ensuring a play free functioning, high load carrying capacity and maximum wear resistance.

GMT system of independent four jaw chucks has separate jaws and reversible hard jaws. This gives the flexibility to use special hard jaws to suit specific component.

The hard jaws are fixed to the base jaws by tongue and tenon, so that they can grip a wide range of components, either on their OD or ID.

Base jaws are made of alloy steel and case-hardened. It is made deeper and wider for providing large bearing areas with reduced unit bearing pressure, thereby increasing the life of the chuck.

Square threads cut on the screws and on the underside of the base jaws have longer mesh with each other, which results in efficient transmission and conversion of applied torque. Screws are heat treated to prevent breakage, a common complaint in the commercial quality chucks.

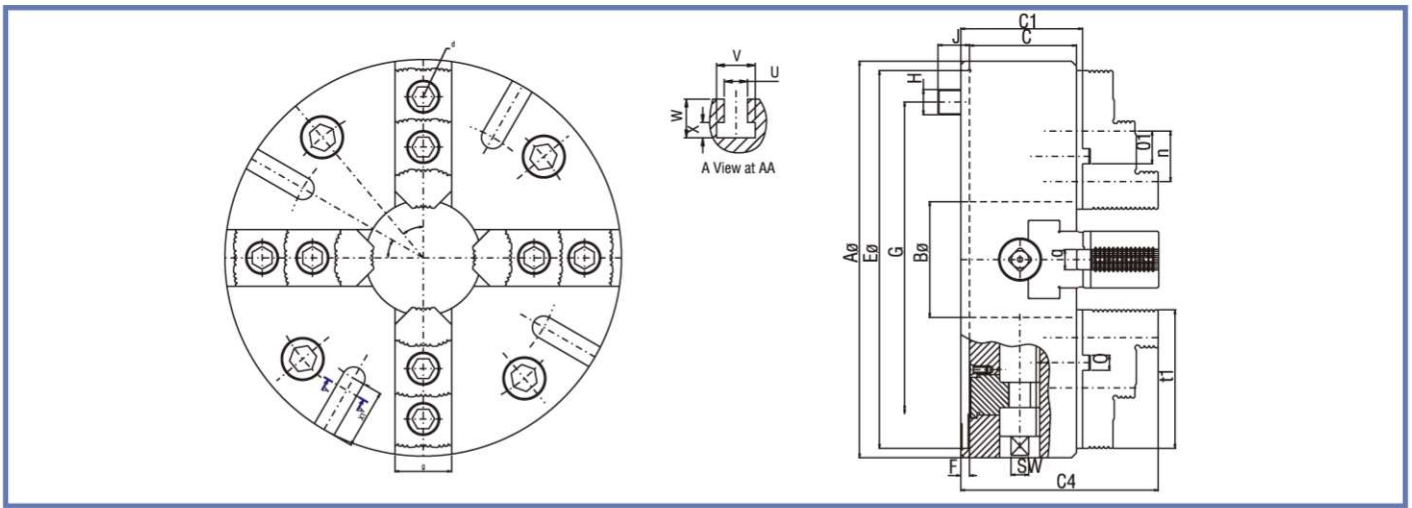

DIMENSIONAL SPECIFICATIONS :

All dimensions in mm

Model	34-06	34-07	34-08	34-09	34-10	34-11	34-12	34-13	34-14	
Size	250	315	400	500	630	800	900	1000	1200	
AØ	250	315	400	500	630	800	900	1000	1200	
BØ	68	92	130	170	245	385	380	380	380	
C	83	86	98	98	108	140	140	140	140	
C1	95	98	110.5	110.5	119	155	155	155	145	
C4	146	158	175	185.5	199	265	280	280.5	280	
EØ H8	235	300	380	460	580	710	710	710	710	
F	7	7	7	7	6	10	10	10	10	
G PCD	200	250	315	400	520	660	660	660	660	
H	4 x M16	4 x M20	4 x M20	4 x M24	4 x M24	8 x M24	8 x M24	8 x M24	8 x M24	
J	24.5	25	38.5	35.5	38	35	35	35	35	
SW	14	14	17	17	17	24	24	24	24	
U H12	14	18	18	22	22	22	22	22	22	
V	23	30	30	37	37	40	40	40	40	
W	25	30	30	38	38	38	38	38	38	
X	9	12	12	16	16	16	16	16	16	
X1	42	47	60	64	160	127	180	230	330	
d	8 x M14	8 x M16	8 x M16	8 x M20	8 x M20	12 x M20	12 x M20	12 x M20	12 x M20	
g	38	45	50	50	60	60	60	60	60	
n	35	40	50	60	60	170	200	200	200	
o g6	12	12	12	12	12	22	22	22	22	
o1	23.5	26	31	36	36	96	111	111	111	
q H7	16	16	16	16	16	22	22	22	22	
t1	93	110	130	160	195	255	300	300	300	
Outer Clamping	Max	250	315	400	500	630	800	900	1000	1200
	Min	20	35	40	58	78	130	130	130	130
Inner Clamping	Max	250	315	400	500	630	800	900	1000	1200
	Min	68	84	106	152	232	320	340	340	340
RPM Max.	2400	1900	1500	1200	1000	500	445	400	335	
Wt. in Kgs. approx.	33	55	90	138	241	425	600	840	1150	

Each chuck is supplied with - one set of reversible hard jaws, one number box spanner with tommy bar, one number allen wrench for jaw screws and one set of body clamping screws

Note : Minimum 2/3 engagement between screw and base jaw to be maintained during clamping.

Shaded sizes are special



Guindy Machine Tools Limited

214, Velachery-Tambaram Main Road, Pallikaranai, Chennai-600 100, INDIA

Tel.: +91-44-22460627 / 28 / 29 Sales Dept.: +91-44-22460811 / 12

Fax. : +91-44-22460112 / +91-44-22460317

E-Mail : gmt@gmt.co.in Web : www.gmt.co.in